

Central Florida Opportunity!!!



- Build When It's Right for You
- Country Living - City Advantages
- Below Market Value
- Below Market Value
- Low Taxes and HOA Dues
- Should Double in Value

Busch Gardens
50 minutes

Universal Studios
50 minutes

Orlando Airport
45 minutes

Tampa Airport
1 hour 20 min

Sea World
45 minutes

Cypress Gardens
10 minutes

Beaches
1 hour 30 min

Disney
25 minutes

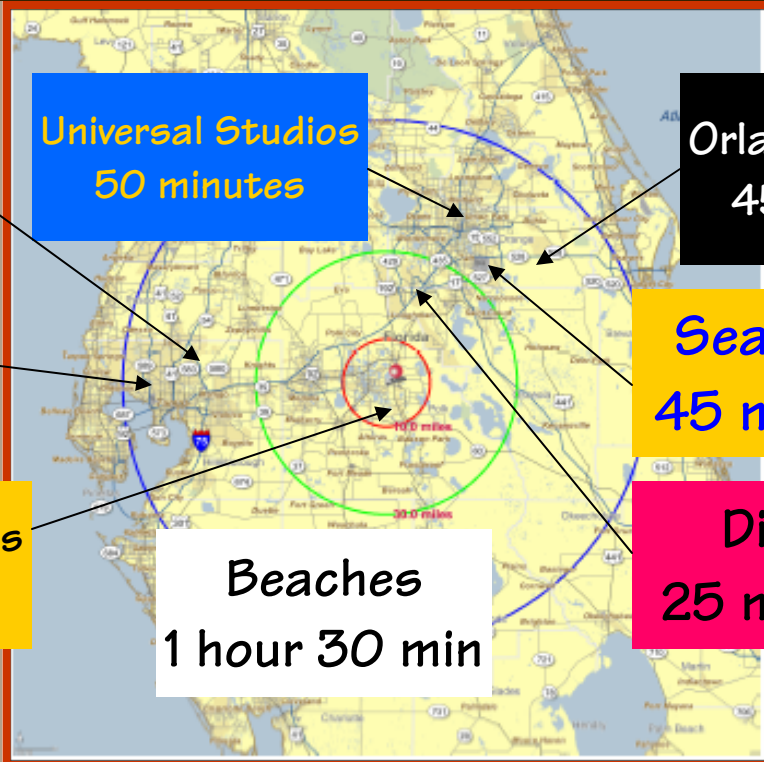

Country Club Estates

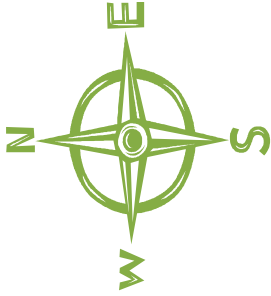

50' X 125'
\$35,500

70' X 125'
\$45,000

Sold

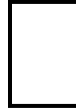

Prices subject to
change.

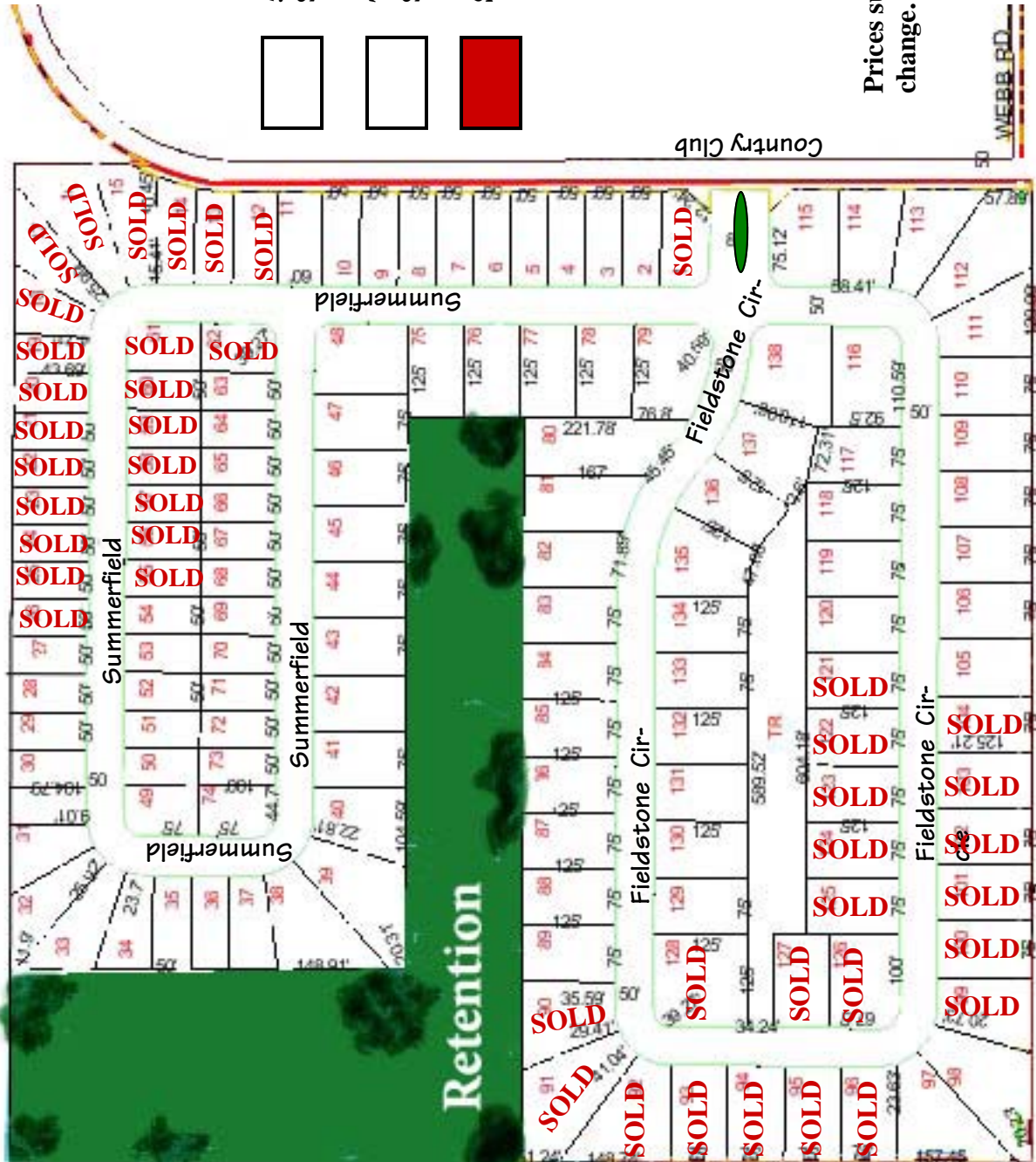

87 Finished Lots Ready for
Immediate Purchase!