

# Coldwell Banker Commercial NRT

## 37 Acres Havendale Boulevard, Auburndale, Florida

For More Information, go to:  
[www.mycommercialteam.com/PolkNursery-Havendale.htm](http://www.mycommercialteam.com/PolkNursery-Havendale.htm)

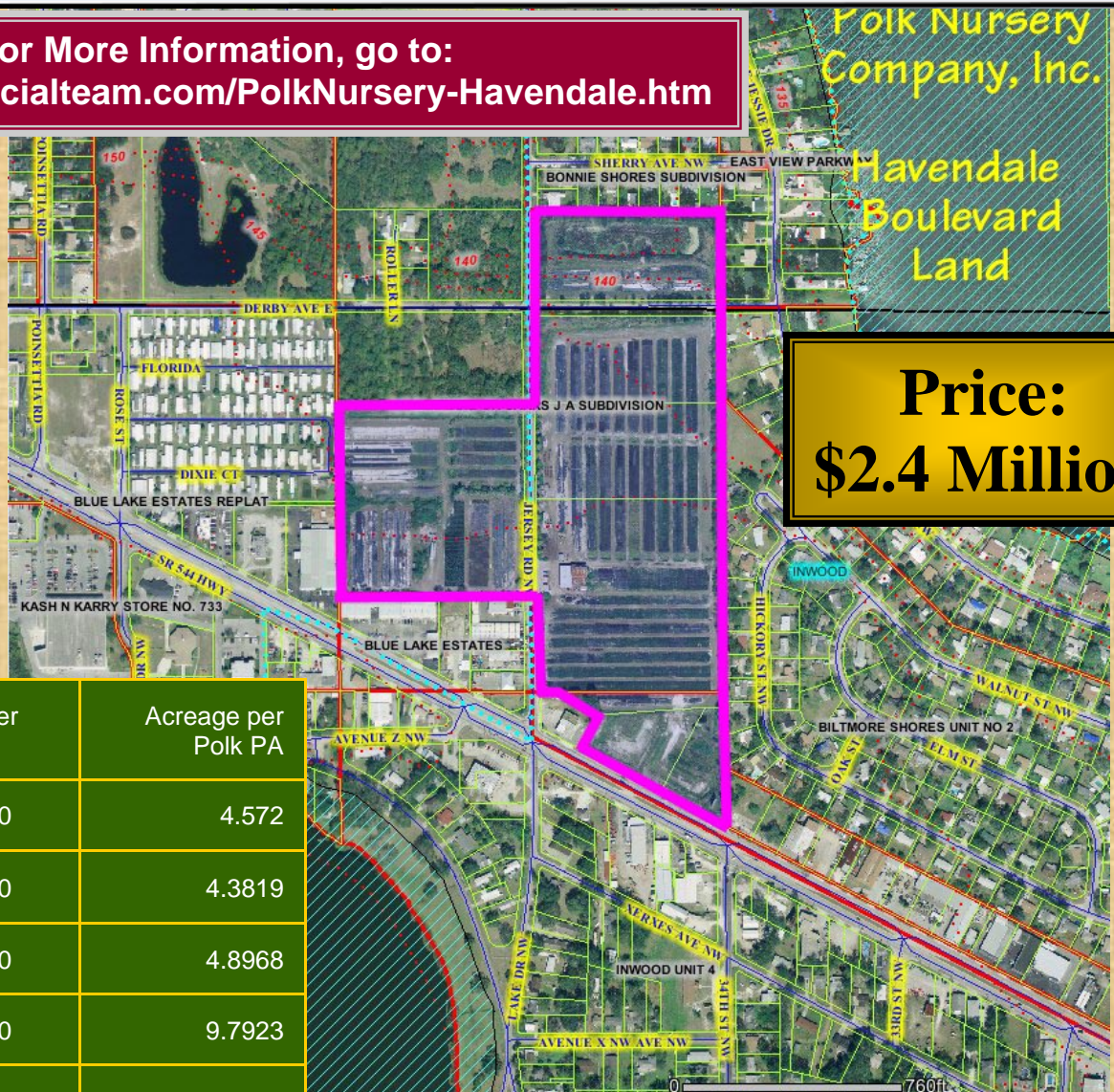

**Price:**  
**\$2.4 Million**

Polk Property Appraiser Parcel ID	Acreage per Polk PA
252812339500000160	4.572
252812339500000170	4.3819
252812339500000200	4.8968
252812339500000210	9.7923
252813000000032010	0.7789
252813000000032020	1.263
252813000000032040	1.664
252812339500000190	9.7785
	=====
<b>TOTAL ACREAGE FOR HAVENDALE PROPERTIES</b>	<b>37.1274</b>

**Mike Nolen Sr., Gloria J. Spanjers**  
**Realtor**  
**Coldwell Banker Commercial NRT**  
**290 Cypress Gardens Blvd.,**  
**Winter Haven, FL 33880**  
**863-294-7541 Office**  
**863-206-4749 Cell Gloria**  
**863-508-1718 Direct line**  
**Gloria@mycommercialteam.com**



NRT

Florida's Commercial Real Estate Company

**POLK NURSERY CO., INC.**  
**HAVENDALE BOULEVARD PROPERTY**

- **37 +/- Acres on Havendale Blvd. (SR 544).**
- **High traffic counts — 30,000/day (2007 FDOT Study)**
- **Located between Auburndale and Winter Haven**
- **Easy access to I-4, US 27, Polk Parkway and US 17-92**
- **Land use — a mixture of Linear Commercial Corridor (LCC) on frontage along Havendale Blvd., with balance designated Residential Low (RL-3, 3 DU/Acre, 10,000 Sq.Ft.).**
- **Water and Sewer Available**
- **48 Miles to Orlando**
- **50 Miles to Tampa**
- **9 Miles from US 27**
- **10 Miles from I-4 (at the Polk Parkway)**

**Mike Nolen Sr., Gloria J. Spanjers**  
**Realtor— 863-294-7541**



**COLDWELL  
BANKER  
COMMERCIAL**

**NRT**

*Florida's Commercial Real Estate Company*

# POLK NURSERY CO., INC. HAVENDALE BOULEVARD PROPERTY

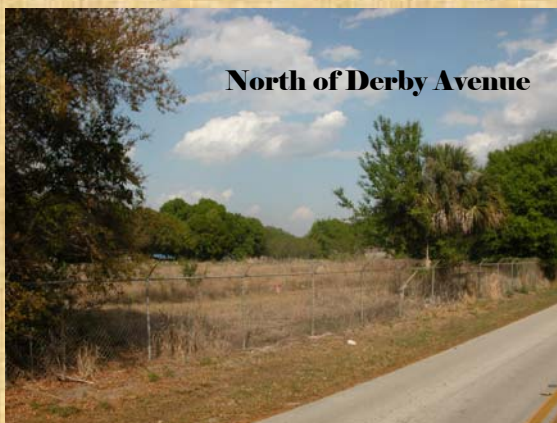
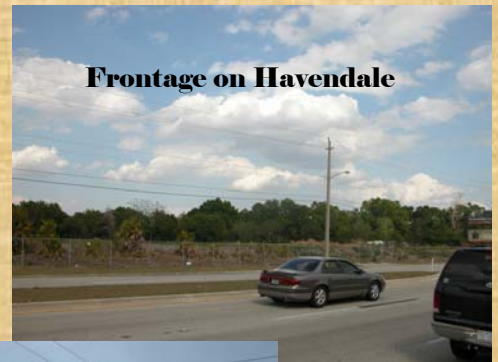

**Mike Nolen Sr., Gloria J. Spanjers  
Realtor— 863-294-7541**



**COLDWELL  
BANKER  
COMMERCIAL**

NRT

*Florida's Commercial Real Estate Company*