

NOTE:
 THIS SITE PLAN IS SCHEMATIC AND HAS NOT
 BEEN GENERATED UTILIZING A TOPOGRAPHIC SURVEY
 CONDUCTED BY A REGISTERED SURVEYOR. THE FINAL
 ACTUAL SITE CONDITIONS TO BE DETERMINED FROM
 THE TOPOGRAPHIC SURVEY TO BE PROVIDED BY THE
 CLIENT AT A LATER DATE.

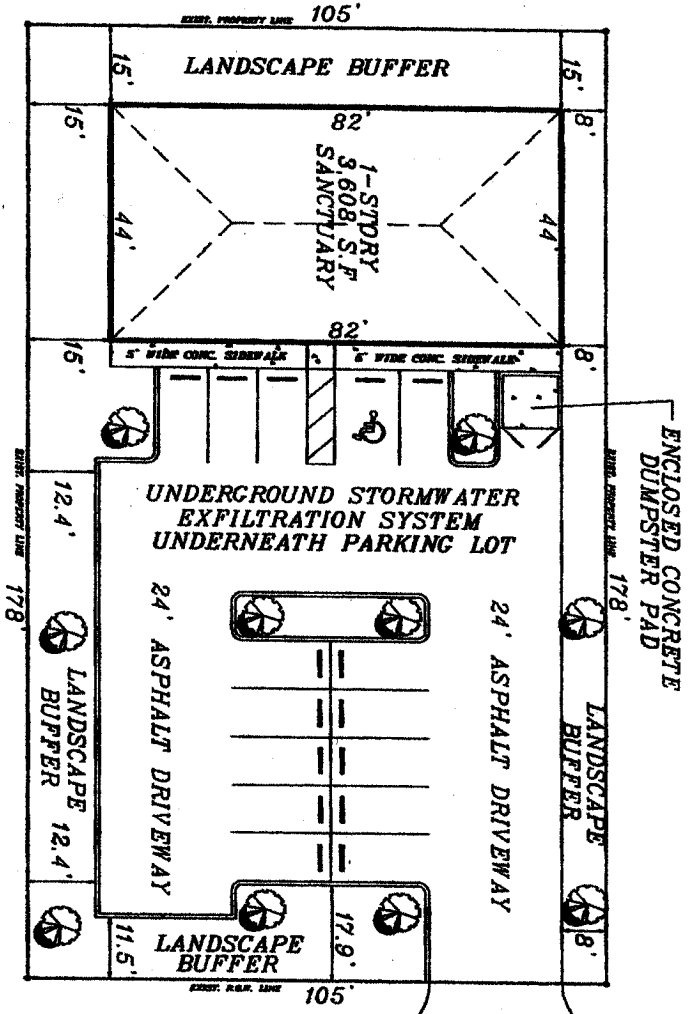

1ST STREET NORTH



LEGAL DESCRIPTION:
 LARSON SUBDIVISION, P.S. 3, PAGE 35, BLOCK 4,
 LOT 6, T15S R15E S1/4 SEC 10N FOR STREET NORTH
 ADDITIONAL N/4 FOR PMSI STREET NORTH

REVISIONS	BY DATE	PROJECT PROGRAM	WILLIAM H. ROBERTS, P.E.	PROPOSED CHURCH PROJECT	PRELIMINARY SITE PLAN
NO. 1		DESIGNER	WILLIAM H. ROBERTS, P.E.	WANNIE JOHNSON	NOT FOR CONSTRUCTION
NO. 2		CHECKED BY	WILLIAM H. ROBERTS, P.E.	WANNIE JOHNSON	
NO. 3		APPROVED BY	WILLIAM H. ROBERTS, P.E.	WANNIE JOHNSON	
NO. 4		SCALE	1"=10'		
NO. 5		DATE	07/20/2010		
NO. 6		PROJECT NO.	01		