

# Coldwell Banker Commercial NRT Interstate 4/US 27 Interchange - Davenport, FL



Prime Commercial Site on  
Frontage Road at the  
Interstate 4/US Highway  
27 Interchange  
**Owner Will Divide**

**4.6 Acres**

**Price: \$16.00 PSF  
(\$3,275,712.00)**

- Great Traffic Counts at this Interchange (31,000 to 54,000 vehicles per day - FDOT Traffic Study)
- Located just north of McDonald's and Wendy's
- Posner City Center to the South
- Four Corners Area to North
- Polk County Land Use - Regional Activity Center (RAC)
- Water and Sewer Available

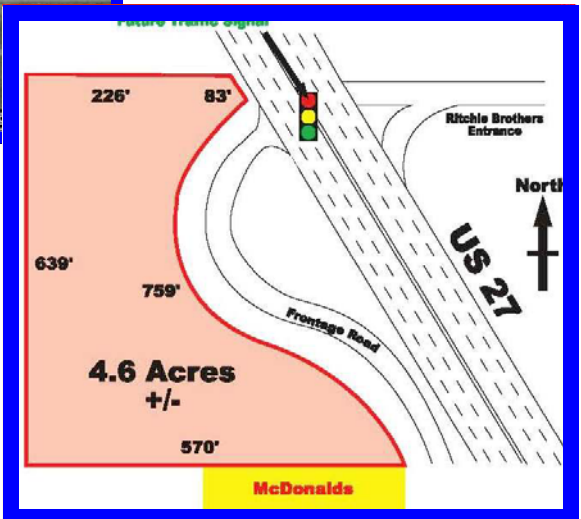

Mike Nolen Sr., Gloria J. Spanjers  
Realtor  
Coldwell Banker Commercial NRT  
290 Cypress Gardens Blvd.,  
Winter Haven, FL 33880  
863-294-7541 Office  
863-325-5856 Cell Mike  
863-508-1718 Direct line  
[Mike@mycommercialteam.com](mailto:Mike@mycommercialteam.com)

# Locator Map

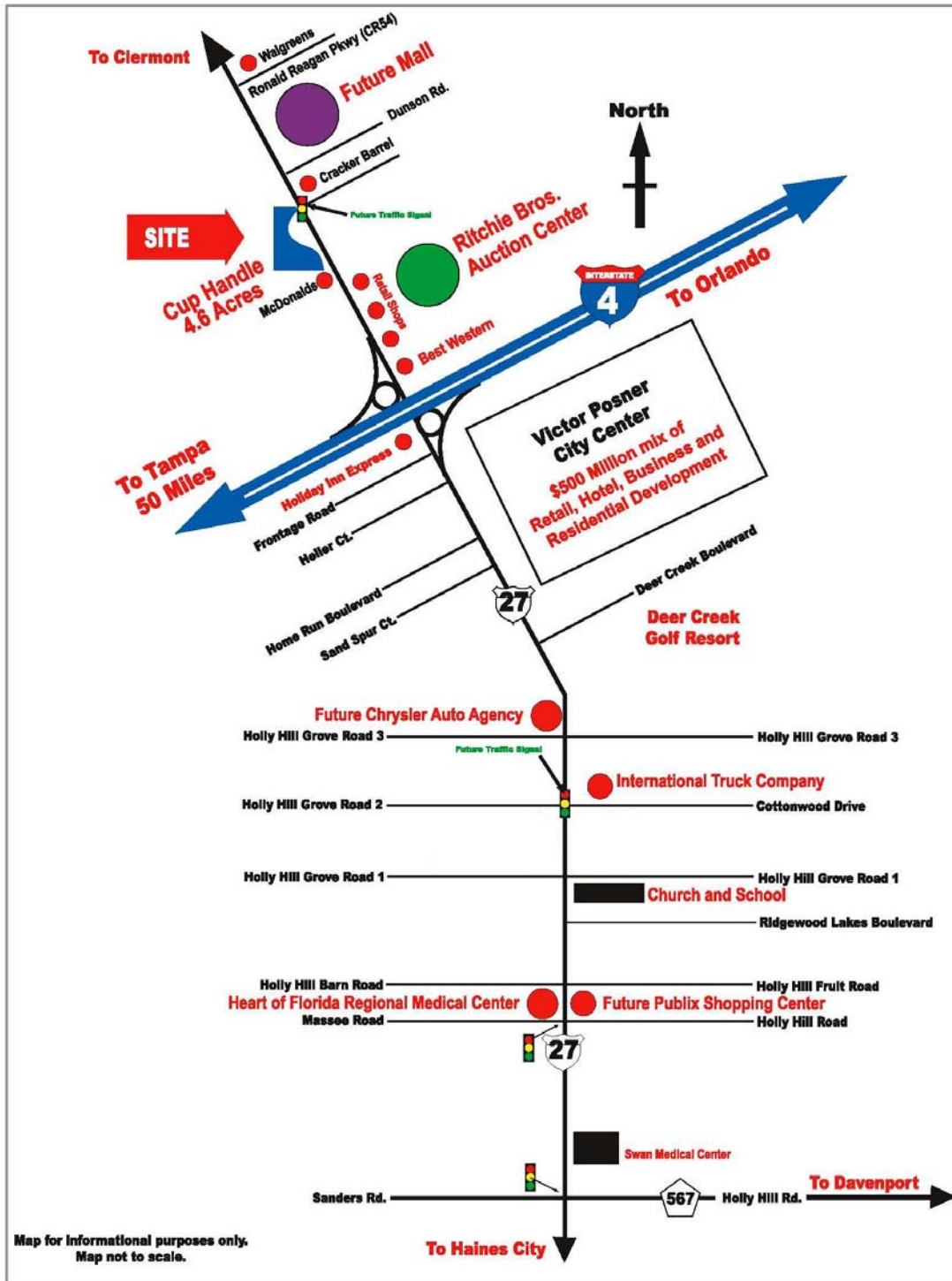

All information contained herein has been obtained from sources deemed reliable. The property information herein is derived from various sources that may include, but not be limited to, county records, a Multiple Listing Service or other commercial listing service. Although the information is believed to be accurate, it is not warranted and you should not rely upon it without personal verification. Coldwell Banker Commercial NRT, nor any agent thereof cannot guarantee this information. We are not responsible for errors, omissions, prior sale, change in price, easements, zoning changes or withdrawal of property from the market without notice.

**Mike Nolen Sr., Gloria J. Spanjers**  
Realtor— 863-294-7541



NRT

Florida's Commercial Real Estate Company